

**RAP - Portacavo per cavi radianti**

sospensioni su funi portanti di acciaio/sintetiche

Il portacavi **RAP**, formato da due gusci incernierati ①, viene utilizzato nelle gallerie per la sospensione di cavi radianti coassiali a funi portanti, sia di acciaio sia di materiale sintetico. Trattiene il cavo coassiale senza comprimerlo né deformarlo. Gancetti elastici ② assicurano la chiusura a scatto e il prefissaggio rapido attorno al cavo e alla fune portante. Due viti ③ garantiscono il fissaggio definitivo del **RAP** sul cavo e sulla fune portante.

**Materiale:**

PA6V0, colore nero, autoestinguente, senza alogeni (accordo UL94 - VO).  
Temperature di esercizio: - 40°C + 125°C



**RAP (Pat.)**

**RAP - Radiating Cable Clamp**

for Hangings on steel/synthetic Ropes

The **RAP** Clamp, consisting of two hinged shells ①, is used in tunnels to hang coaxial radiating cables to ropes made of either steel or synthetic materials. It holds the coaxial cable without compressing nor deforming it. Some small elastic snap-in hooks ② guarantee the closure as well as a quick pre-fixing around cable and rope. Two screws ③ assure the final fixing of **RAP** Clamp on cable and rope.

**Materials:**

PA6V0, black colour, self extinguishing, halogen free (according to UL94 - VO).  
Operating temperature : - 40°C + 125°C

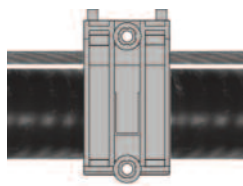

- Ganci per prefissaggio
- Pre-fixing hooks
- Vorbefestigung durch Haken
- Crochet pour pré-fixations

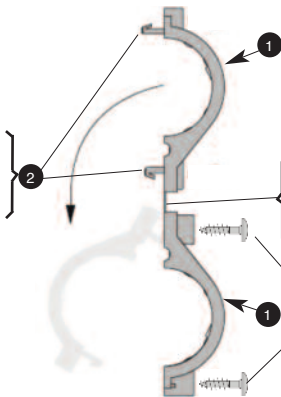

- Cerniera flessibile (brev.)
- Flexible hinge (Pat.)
- Flexibles Scharniergelenk (Pat.)
- Charnière flexible (Brev.)

- Viti TORX
- TORX screws
- TORX Schrauben
- Vis TORX

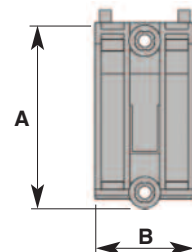
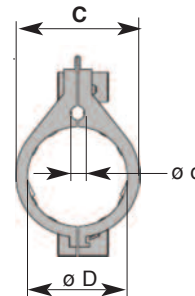

| Figura<br>Figure<br>Abbildung<br>Figure | Codice<br>Code<br>Artikel Nr.<br>Code | Articolo<br>Article<br>Artikel<br>Article | A  | B  | C  | ø d | ø D   | g  | Prezzo<br>Price<br>Preis<br>Code |
|-----------------------------------------|---------------------------------------|-------------------------------------------|----|----|----|-----|-------|----|----------------------------------|
|                                         | 61 5050 0078                          | <b>RAP 7/8"</b>                           | 74 | 50 | 40 | 6-7 | 27-28 | 50 | 41                               |
|                                         | 61 5050 0114                          | <b>RAP 1.1/4"</b>                         | 83 | 50 | 51 | 6-7 | 39-40 | 50 | 48                               |
|                                         | 61 5050 0158                          | <b>RAP 1.5/8"</b>                         | 94 | 50 | 62 | 6-7 | 50-52 | 50 | 54                               |

Fune portante  
Hanging rope  
Trageseil  
Câble porteur

Cavo radiante  
Radiating cable  
Abstrahlendes Kabel  
Câble rayonnant

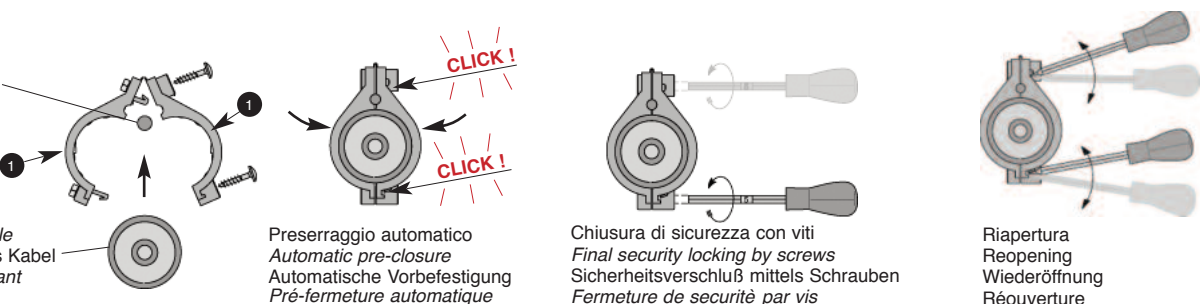

Preserraggio automatico  
Automatic pre-closure  
Automatische Vorbefestigung  
Pré-fermeture automatique

Chiusura di sicurezza con viti  
Final security locking by screws  
Sicherheitsverschluß mittels Schrauben  
Fermeture de sécurité par vis

Riapertura  
Reopening  
Wiederöffnung  
Réouverture

**SOLUZIONI**  
**PER L'INSTALLAZIONE**

**SOLUTIONS**  
**FOR INSTALLATIONS**



**LÖSUNGEN**  
**FÜR INSTALLATIONEN**

**SOLUTIONS**  
**POUR L'INSTALLATION**