

# 50-Ohm Load

## 698 – 2700 MHz

### 80 W

- Designed as 50-Ohm termination wherever improved intermodulation performance compared to standard loads is required
- **Excellent intermodulation performance**
- Suitable for indoor or outdoor applications
- Wall or mast mounting
- Built-in DC stop

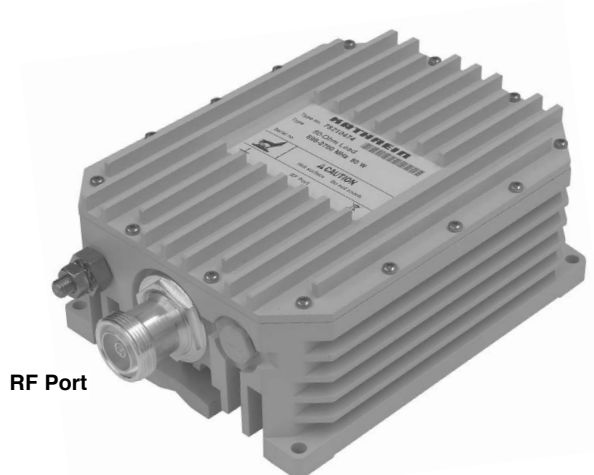

RF Port

#### Technical Data

Type No.	<b>782 10474</b>
Frequency range	698 – 2700 MHz
VSWR	< 1.12
Impedance	50 Ω
Input power	< 80 W (see table)
Intermodulation products	< -160 dBc (3 <sup>rd</sup> order; with 2 x 20 W)
Temperature range	-40 ... +55 °C
Connector	7-16 female (long neck)
Application	Indoor <i>or</i> outdoor (IP 66)
DC/AISG transparency	Built-in DC stop AISG: Attenuation up to 3 dB when used in a network
Mounting	Wall mounting: With 4 screws (max. 6.5 mm diameter) Mast mounting: With additional clamp set (see page 2)
Weight	3.1 kg
Packing size	377 x 232 x 189 mm
Dimensions (w x h x d)	143.6 x 216 x 79.2 mm (including connector)

#### Note:

The RF port connector should always point downwards if mounted outdoors.

The input power rating of 80 W is specified at an ambient temperature of +40 °C with the combiner mounted vertically, without additional cooling, and while respecting the safety standard EN IEC 60950 (max. surface temperature +90 °C).

The max. power rating increases or decreases with falling or rising ambient temperature and depending on horizontal or vertical mounting in accordance with the following table:

#### Max. input power

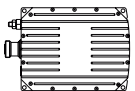
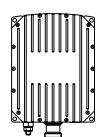
	Mounted horizontally	Mounted vertically
Max. ambient temperature		
+55 °C	50 W	60 W
+40 °C	70 W	<b>80 W</b>
+25 °C	90 W	100 W

# 50-Ohm Load

## 698 – 2700 MHz

### 80 W

#### Accessories (order separately)

Type No.	Clamp set suitable for mast diameter of
734 360	34 – 60 mm
734 361	60 – 80 mm
734 362	80 – 100 mm
734 363	100 – 120 mm
734 364	120 – 140 mm
<b>734 365</b>	<b>45 – 125 mm</b>



#### Mast mounting with Kathrein Clamp set 734 360 ... 734 365

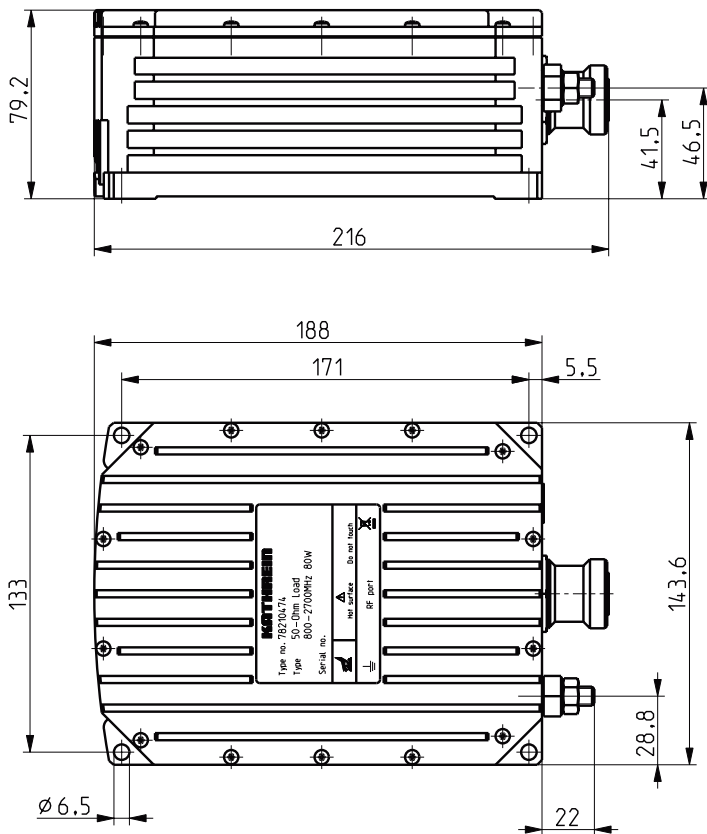
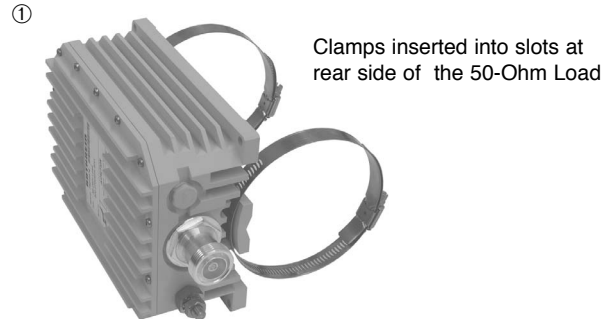

#### Please note:

**As a result of more stringent legal regulations and judgements regarding product liability, we are obliged to point out certain risks that may arise when products are used under extraordinary operating conditions.**

Extraordinary operating conditions, such as heavy icing or exceptional dynamic stress (e.g. strain caused by oscillating support structures), may result in the breakage of a mast mounted device or even cause it to fall to the ground.

These facts must be considered during the site planning process.

The 50-Ohm Load is designed to operate under the environmental conditions as described in ETS 300 019-1-4 class 4.1 E and have passed environmental tests as recommended in ETS 300 019-2-4.

**The installation team must be properly qualified and also be familiar with the relevant national safety regulations.**

**The details given in our data sheets have to be followed carefully when installing the combiner and accessories.**

**The limits for the coupling torque of RF connectors, recommended by the connector manufacturers must be obeyed.**

**Any previous datasheet issues have now become invalid.**

