

19

Inter-Series Adaptors **Adapter zwischen den Serien**

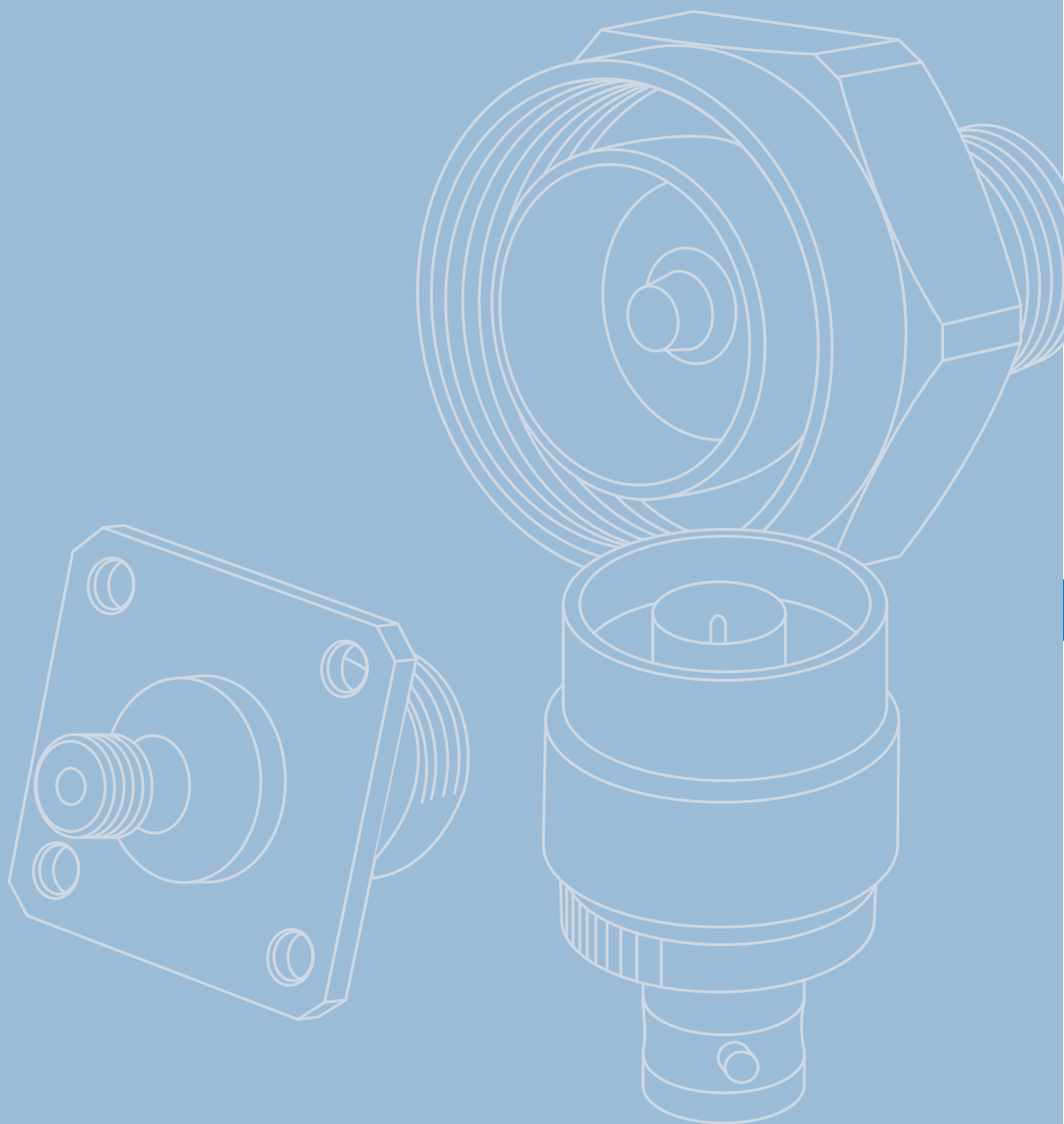



19

Inter-Series Adaptors Adapter zwischen den Serien

19.1	BNC to TNC	332	19.1	BNC auf TNC	332
19.2	BNC to N	333	19.2	BNC auf N	333
19.3	BNC to UHF	333	19.3	BNC auf UHF	333
19.4	BNC to Mini UHF	334	19.4	BNC auf Mini-UHF	334
19.5	Angle Adaptor BNC to Mini UHF	335	19.5	Winkeladapter BNC auf Mini-UHF	335
19.6	BNC to 4/13	335	19.6	BNC auf 4/13	335
19.7	BNC to FME	335	19.7	BNC auf FME	335
19.8	Angle Adaptor BNC to FME	336	19.8	Winkeladapter BNC auf FME	336
19.9	BNC to SMA	337	19.9	BNC auf SMA	337
19.10	BNC to SMB	338	19.10	BNC auf SMB	338
19.11	BNC to 1.6/5.6	339	19.11	BNC auf 1.6/5.6	339
19.12	BNC to F	340	19.12	BNC auf F	340
19.13	BNC to Cinch	341	19.13	BNC auf Cinch	341
19.14	TNC to N	341	19.14	TNC auf N	341
19.15	TNC to UHF	342	19.15	TNC auf UHF	342
19.16	TNC to Mini-UHF	343	19.16	TNC auf Mini-UHF	343
19.17	Angle Adaptor TNC to Mini UHF	343	19.17	Winkeladapter TNC auf Mini-UHF	343
19.18	TNC to FME	343	19.18	TNC auf FME	343
19.19	Angle Adaptor TNC to FME	344	19.19	Winkeladapter TNC auf FME	344
19.20	TNC to SMA	344	19.20	TNC auf SMA	344
19.21	TNC Bulkhead to SMA	344	19.21	TNC auf SMA mit Flansch	344
19.22	TNC to MCX	345	19.22	TNC auf MCX	345
19.23	N to Mini UHF	345	19.23	N auf Mini-UHF	345
19.24	N to FME	346	19.24	N auf FME	346
19.25	Angle Adaptor N to FME	346	19.25	Winkeladapter N auf FME	346
19.26	N to SMA	346	19.26	N auf SMA	346
19.27	UHF to N	348	19.27	UHF auf N	348
19.28	UHF to Mini UHF	349	19.28	UHF auf Mini-UHF	349
19.29	UHF to FME	349	19.29	UHF auf FME	349
19.30	Mini UHF to FME	349	19.30	Mini-UHF auf FME	349
19.31	Angle Adaptor Mini UHF to FME	350	19.31	Winkeladapter Mini-UHF auf FME	350
19.32	M to FME	350	19.32	M auf FME	350
19.33	FME to SMA	351	19.33	FME auf SMA	351
19.34	SMA to SMB	351	19.34	SMA auf SMB	351
19.35	7/16 to N	352	19.35	7-16 auf N	352
19.36	Bulkhead Adaptor R-SMA to UMTC (U.FL)	354	19.36	Einbauadapter R-SMA auf UMTC (U.FL)	354
19.37	SMA to R-SMA	354	19.37	SMA auf R-SMA	354
19.38	TNC to R-TNC	355	19.38	TNC auf R-TNC	355
19.39	SMA to Push-On SMA	355	19.39	SMA auf Push-On SMA	355
19.40	QLS to SMA	356	19.40	QLS auf SMA	356

Inter-Series Adaptors Adapter zwischen den Serien

		BNC 50 Ohm		BNC 75 Ohm		TNC		R-TNC		N		UHF		MiniUHF	
		m	f	m	f	m	f	m	f	m	f	m	f	m	f
BNC 50 Ohm	m	J01004 A0806	J01004 A0617			J01008 A0011	J01008 B0010			J01008 A0824		J01008 A0803		J01008 F0073	
	f	J01004 A0617	J01004 A0618+			J01019 B0000	J01008 A0012			J01008 A0825	J01008 A0088	J01008 A0801	J01008 A0024	J01008 F0072+	
BNC 75 Ohm	m			J01005 A1230	J01005 A1237										
	f			J01005 A1237	J01005 A0006+										
TNC	m	J01008 A0011	J01019 B0000			J01014 A2806	J01014 A0001		J01014 R0000		J01019 A0008		J01019 A0003		J01019 F0019
	f	J01008 B0010	J01008 A0012			J01014 A0001	J01014 A2618+	J01014 R0001		J01019 A0007	J01019 A0025	J01019 A0002		J01019 A0020+	
R-TNC	m						J01014 R0001								
	f					J01014 R0000									
N	m		J01008 A0825				J01019 A0007			J01024 J1094	J01024 J1096		J01043 A0832		J01027 F0012
	f	J01008 A0824	J01008 A0088			J01019 A0008	J01019 A0025			J01024 J1096	J01024 A0004+	J01043 A0831		J01027 F0011	
UHF	m		J01008 A0801				J01019 A0002			J01043 A0831	J01042 A0653	J01042 F0652		J01043 F0002	
	f	J01008 A0803	J01008 A0024			J01019 A0003			J01043 A0832		J01042 F0652	J01042 A0637			
MiniUHF	m		J01008 F0072+				J01019 A0020+			J01027 F0011					
	f	J01008 F0073				J01019 F0019			J01027 F0012		J01043 F0002			J01047 F0001	
M	m														
	f														
7-16	m									J01122 A0009					
	f									J01122 A0011	J01122 A0008				
4/13	m		J01008 A0802												
	f														
FME	m	J01008 A0014+	J01008 F0068			J01019 A0004+				J01027 A0013+		J01043 A0000		J01048 A0000+	
	f		J01008 A0070												
SMB	m	J01008 G0038	J01008 F0033												
	f	J01008 F0030	J01008 F0013												
QLS	m														
	f														
SMA	m	J01008 A0018	J01008 A0025				J01019 B0029			J01027 A0019	J01027 A0016				
	f	J01008 A0017	J01008 A0019				J01019 A0028			J01027 A0018	J01027 A0017+				
R-SMA	m														
	f														
Push-On SMA	m														
	f														
MCX	m														
	f						J01019 A0005+								
1.6/5.6	m	J01008 A0810	J01008 A0812												
	f	J01008 A0813	J01008 A0811												
Cinch	m		J01008 A0838												
	f	J01008 A0839													
F	m		J01008 A0031												
	f	J01008 A0023	J01008 A0021												
U.FL	m														
	f														

Inter-Series Adaptors Adapter zwischen den Serien

		M		7-16		4/13		FME		SMB		QLS		SMA	
		m	f	m	f	m	f	m	f	m	f	m	f		
BNC 50 Ohm	m							J01008 A0014+		J01008 G0038	J01008 F0030			J01008 A0018	J01008 A0017
	f					J01008 A0802		J01008 F0068	J01008 F0070	J01008 F0033	J01008 F0013			J01008 A0025	J01008 A0019
BNC 75 Ohm	m														
	f														
TNC	m							J01019 A0004+							
	f													J01019 B0029	J01019 A0028
R-TNC	m														
	f														
N	m			J01122 A0009	J01122 A0011			J01027 A0013+						J01027 A0019	J01027 A0018
	f				J01122 A0008									J01027 A0016	J01027 A0017
UHF	m							J01043 A0000							
	f														
MiniUHF	m							J01048 A0000+							
	f														
M	m							J01053 A0000							
	f														
7-16	m			J01123 B0000	J01123 B0004+										
	f			J01123 B0004+	J01123 B0001+										
4/13	m														
	f														
FME	m	J01053 A0000						J01702 A0001						J01703 A0009	J01703 A0000
	f														
SMB	m														
	f														
QLS	m														J01423 A0000
	f														J01423 A0001
SMA	m							J01703 A0009						J01154 A0031	J01154 A0021
	f							J01703 A0000			J01423 A0000	J01423 A0001		J01154 A0021	J01154 A0001+
R-SMA	m														J01155 R0095
	f													J01155 R0085	
Push-On SMA	m														J01155 A0099
	f														
MCX	m														
	f														
1.6/5.6	m														
	f														
Cinch	m														
	f														
F	m														
	f														
U.FL	m														
	f														

Inter-Series Adaptors Adapter zwischen den Serien

		R-SMA		Push-On SMA		MCX		1.6/5.6		Cinch		F		U.FL	
		m	f	m	f	m	f	m	f	m	f	m	f		
BNC 50 Ohm	m							J01008 A0810	J01008 A0813		J01008 A0839		J01008 A0023		
	f							J01008 A0812	J01008 A0811	J01008 A0838		J01008 A0031	J01008 A0021		
<i>BNC</i> 75 Ohm	m														
	f														
TNC	m														
	f						J01019 A0005+								
R-TNC	m														
	f														
N	m														
	f														
UHF	m														
	f														
MiniUHF	m														
	f														
M	m														
	f														
7-16	m														
	f														
4/13	m														
	f														
FME	m														
	f														
SMB	m														
	f														
QLS	m														
	f														
SMA	m		J01155 R0085												
	f	J01155 R0095		J01155 A0099											
R-SMA	m														
	f												J01155 R0061		
Push-On SMA	m														
	f														
MCX	m														
	f														
1.6/5.6	m							J01074 A1704							
	f								J01074 B1705						
Cinch	m														
	f														
F	m														
	f														
U.FL	m		J01155 R0061												
	f														

19.1

BNC to TNC BNC auf TNC

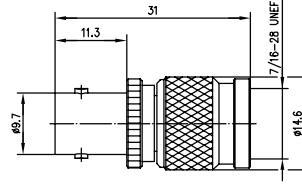

Order No. Bestell-Nr.	Remarks Anmerkungen	Return Loss Return Loss
J01019B0000	f-m Bu-Sti	27 dB/1 GHz; 24 dB/4 GHz

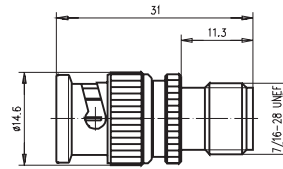

Order No. Bestell-Nr.	Remarks Anmerkungen
J01008B0010	m-f Sti-Bu

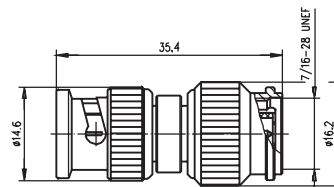

Order No. Bestell-Nr.	Remarks Anmerkungen
J01008A0011	m-m Sti-Sti

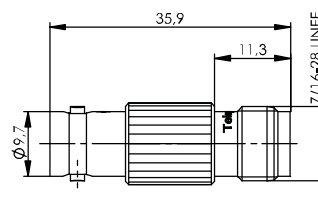

Order No. Bestell-Nr.	Remarks Anmerkungen	Return Loss Return Loss
J01008A0012	f-f Bu-Bu	27 dB/1 GHz; 24 dB/4 GHz

BNC to N BNC auf N

19.2

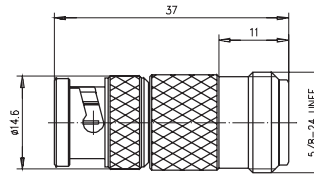

Order No. Bestell-Nr.	Remarks Anmerkungen	Return Loss Return Loss	MIL-Std. MIL-Std.
J01008A0824	m-f Sti-Bu	29 dB/1 GHz; 22,5 dB/4 GHz	UG-349 A/U

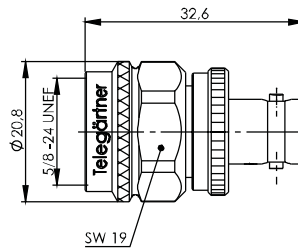

Order No. Bestell-Nr.	Remarks Anmerkungen	Return Loss Return Loss	MIL-Std. MIL-Std.
J01008C0825	f-m Bu-Sti	40 dB/1 GHz; 26 dB/4 GHz	UG-201/U

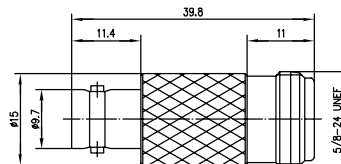

Order No. Bestell-Nr.	Remarks Anmerkungen	Return Loss Return Loss
J01008A0888	f-f BNC-centre contact Ag Bu-Bu, BNC-Innenleiter Ag	34 dB/1 GHz; 26 dB/4 GHz

BNC to UHF BNC auf UHF

19.3

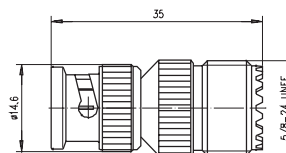

Order No. Bestell-Nr.	Remarks Anmerkungen	MIL-Std. MIL-Std.
J01008A0803	m-f Sti-Bu	UG-255/U

19.3

Inter-Series Adaptors Adapter zwischen den Serien

19.3

BNC to UHF BNC auf UHF

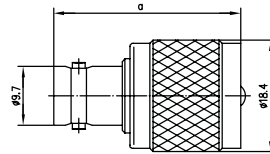

Order No. Bestell-Nr.	Remarks Anmerkungen	Dimensions Abmessungen	MIL-Std. MIL-Std.
J01008A0801	f-m Bu-Sti	a=31	UG-273/U

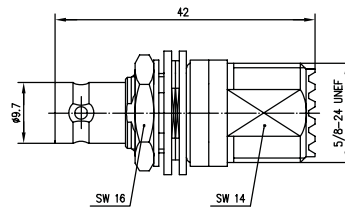

Order No. Bestell-Nr.	Remarks Anmerkungen	Mount. dim. Einbaumaß
J01008A0024	f-f, bulkhead type with insulating washers Bu-Bu, Einbautyp mit Isolierscheiben	Z52

19.4

BNC to Mini UHF BNC auf Mini-UHF

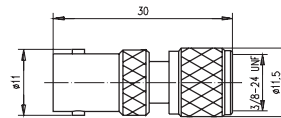

Order No. Bestell-Nr.	Remarks Anmerkungen
J01008F0072	f-m Bu-Sti

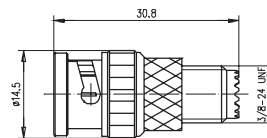

Order No. Bestell-Nr.	Remarks Anmerkungen
J01008F0073	m-f Sti-Bu

Angle Adaptor BNC to Mini UHF Winkeladapter BNC auf Mini-UHF

19.5

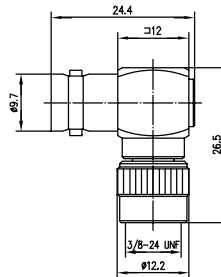

Order No. Bestell-Nr.	Remarks Anmerkungen
J01008A0074	f-m Bu-Sti

BNC to 4/13 BNC auf 4/13

19.6

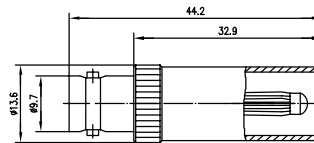

Order No. Bestell-Nr.	Remarks Anmerkungen
J01008A0802	DIN 47283; f-m DIN 47283; Bu-Sti

BNC to FME BNC auf FME

19.7

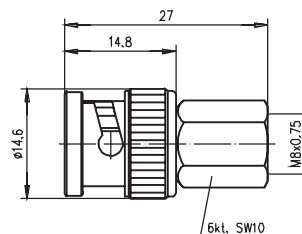
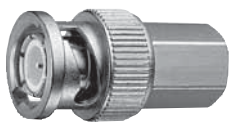

Order No. Bestell-Nr.	Remarks Anmerkungen
J01008A0014	m-m Sti-Sti

19.7

Inter-Series Adaptors Adapter zwischen den Serien

19.7

BNC to FME BNC auf FME

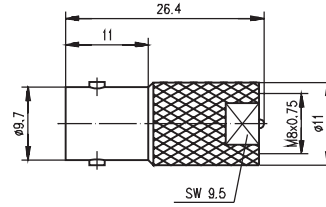

Order No. Bestell-Nr.	Remarks Anmerkungen	Return Loss Return Loss
J01008F0068	f-m Bu-Sti	43 dB/1 GHz; 29 dB/2 GHz

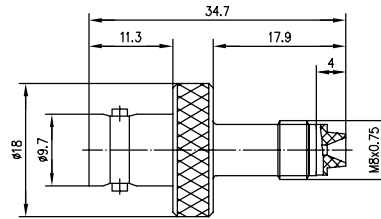

Order No. Bestell-Nr.	Remarks Anmerkungen
J01008A0070	f-f Bu-Bu

19.8

Angle Adaptor BNC to FME Winkeladapter BNC auf FME

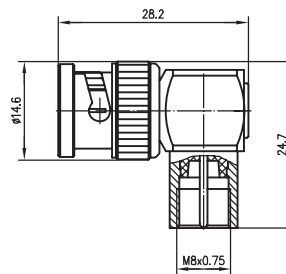
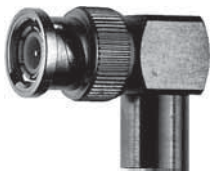

Order No. Bestell-Nr.	Remarks Anmerkungen
J01008A0059	m-m Sti-Sti

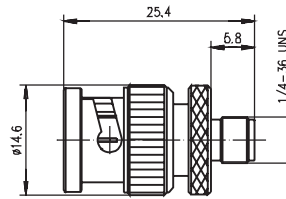

Order No. Bestell-Nr.	Remarks Anmerkungen	Return Loss Return Loss
J01008A0017	m-f Sti-Bu	20 dB/3 GHz

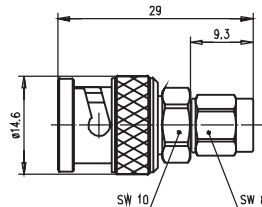

Order No. Bestell-Nr.	Remarks Anmerkungen	Return Loss Return Loss
J01008A0018	m-m Sti-Sti	20 dB/3 GHz

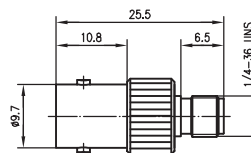
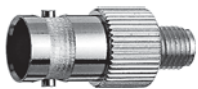

Order No. Bestell-Nr.	Remarks Anmerkungen	Return Loss Return Loss
J01008A0019	f-f Bu-Bu	35,5 dB/1 GHz; 23,5 dB/3 GHz

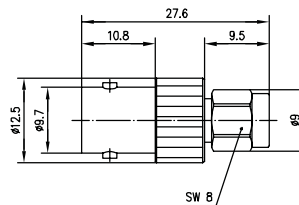

Order No. Bestell-Nr.	Remarks Anmerkungen	Return Loss Return Loss
J01008A0025	f-m Bu-Sti	20 dB/3 GHz

19.10

BNC to SMB BNC auf SMB

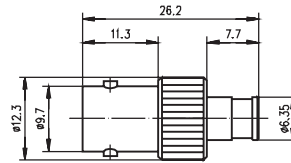

Order No. Bestell-Nr.	Remarks Anmerkungen	Return Loss Return Loss
J01008F0013	f-f Bu-Bu	40 dB/1 GHz; 24 dB/3 GHz

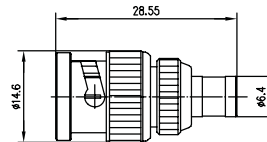

Order No. Bestell-Nr.	Remarks Anmerkungen	Return Loss Return Loss
J01008F0030	m-f Sti-Bu	28 dB/1 GHz; 25.5 dB/3 GHz

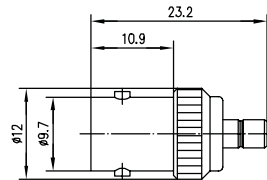
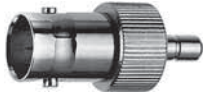

Order No. Bestell-Nr.	Remarks Anmerkungen	Return Loss Return Loss
J01008F0033	f-m Bu-Sti	25 dB/1 GHz; 22 dB/3 GHz

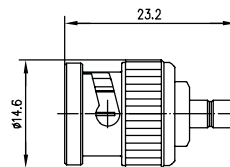

Order No. Bestell-Nr.	Remarks Anmerkungen	Return Loss Return Loss
J01008G0038	m-m Sti-Sti	25 dB/1 GHz; 22 dB/3 GHz

**BNC to 1.6/5.6
BNC auf 1.6/5.6**

19.11

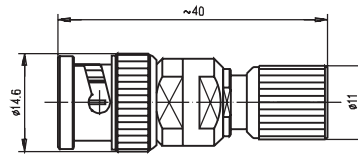

**Order No.
Bestell-Nr.**

**Remarks
Anmerkungen**

J01008A0810

m-m
Sti-Sti

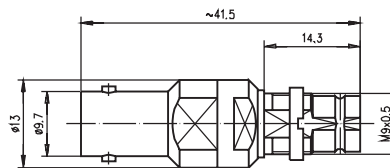

**Order No.
Bestell-Nr.**

**Remarks
Anmerkungen**

**Mount. dim.
Einbaumaß**

J01008A0811

f-f
Bu-Bu

Z32

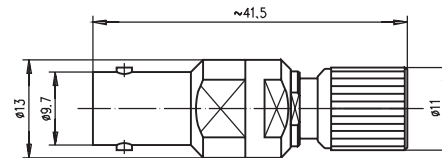

**Order No.
Bestell-Nr.**

**Remarks
Anmerkungen**

J01008A0812

f-m
Bu-Sti

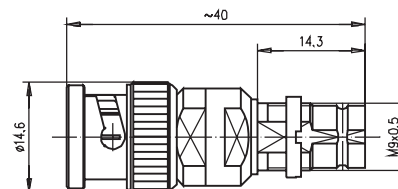

**Order No.
Bestell-Nr.**

**Remarks
Anmerkungen**

**Mount. dim.
Einbaumaß**

J01008A0813

m-f
Sti-Bu

Z32

19.12

BNC to F

BNC auf F

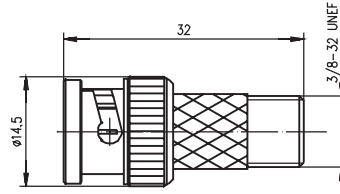

Order No. Bestell-Nr.	Remarks Anmerkungen
J01008A0023	m-f Sti-Bu

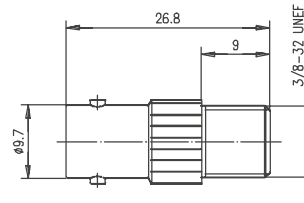

Order No. Bestell-Nr.	Remarks Anmerkungen
J01008A0021	f-f Bu-Bu

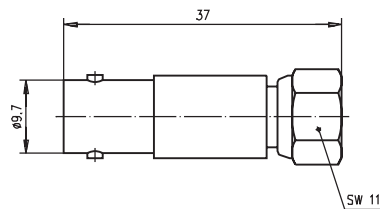

Order No. Bestell-Nr.	Remarks Anmerkungen
J01008A0031	f-m Bu-Sti

BNC to Cinch BNC auf Cinch

19.13

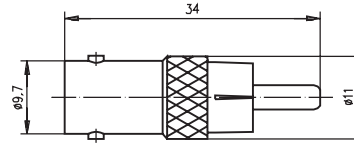

Order No. Bestell-Nr.	Remarks Anmerkungen
J01008A0838	f-m Bu-Sti

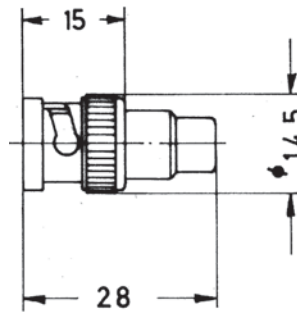

Order No. Bestell-Nr.	Remarks Anmerkungen
J01008A0839	m-f Sti-Bu

TNC to N TNC auf N

19.14

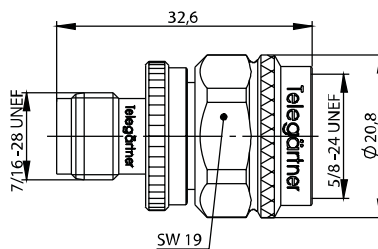

Order No. Bestell-Nr.	Remarks Anmerkungen	Return Loss Return Loss
J01019C0007	f-m Bu-Sti	36 dB/1 GHz; 23 dB/4 GHz

19.14

Inter-Series Adaptors Adapter zwischen den Serien

19.14

TNC to N TNC auf N

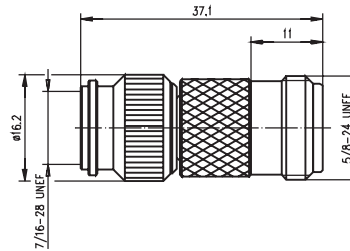
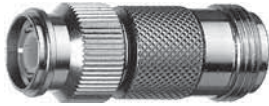

Order No. Bestell-Nr.	Remarks Anmerkungen
J01019A0008	m-f Sti-Bu

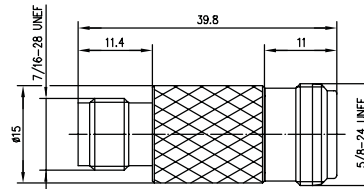
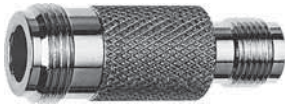

Order No. Bestell-Nr.	Remarks Anmerkungen	Return Loss
J01019A0025	f-f Bu-Bu	33 dB/1 GHz; 25 dB/ 6 GHz

19.15

TNC to UHF TNC auf UHF

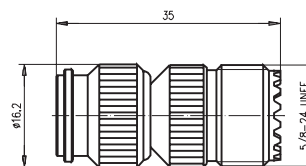

Order No. Bestell-Nr.	Remarks Anmerkungen
J01019A0003	m-f TNC-centre contact Ag Sti-Bu, TNC-Innenleiter Ag

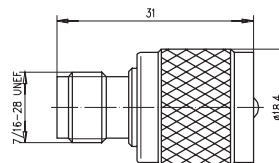

Order No. Bestell-Nr.	Remarks Anmerkungen
J01019A0002	f-m Bu-Sti

TNC to Mini-UHF TNC auf Mini-UHF

19.16

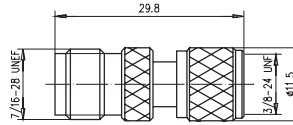

Order No. Bestell-Nr.	Remarks Anmerkungen
J01019F0018	f-m Bu-Sti

Angle Adaptor TNC to Mini UHF Winkeladapter TNC auf Mini-UHF

19.17

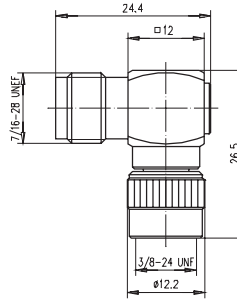
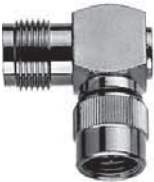

Order No. Bestell-Nr.	Remarks Anmerkungen
J01019A0020	f-m Bu-Sti

TNC to FME TNC auf FME

19.18

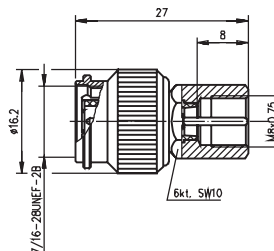

Order No. Bestell-Nr.	Remarks Anmerkungen
J01019A0004	m-m inner conductor Ag Sti-Sti Innenleiter Ag

Inter-Series Adaptors Adapter zwischen den Serien

19.19

Angle Adaptor TNC to FME Winkeladapter TNC auf FME

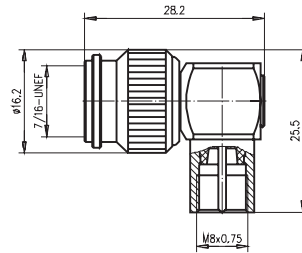

Order No. Bestell-Nr.	Remarks Anmerkungen
J01019A0012	m-m Sti-Sti

19.20

TNC to SMA TNC auf SMA

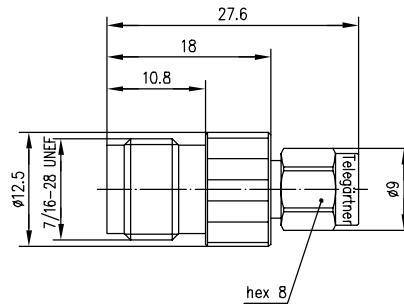

Order No. Bestell-Nr.	Remarks Anmerkungen
J01019B0029	f-m Bu-Sti

19.21

TNC Bulkhead to SMA TNC auf SMA mit Flansch

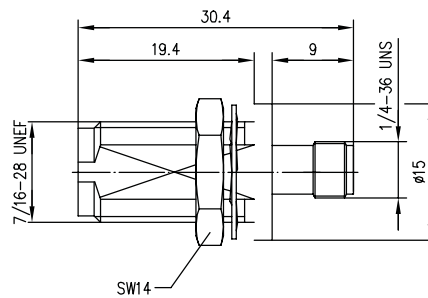

Order No. Bestell-Nr.	Remarks Anmerkungen	Mount. dim. Einbaumaß
J01019A0028	f-f; bulkhead adaptor; stainless steel body; 32 dB/4 GHz; 20 dB/18 GHz Bu-Bu; Einbautype; Körper aus rostfreiem Stahl; 32 dB/4 GHz; 20 dB/18 GHz	Z03

TNC to MCX TNC auf MCX

19.22

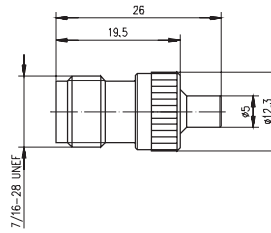

Order No. Bestell-Nr.	Remarks Anmerkungen
J01019A0024	f-f Bu-Bu

N to Mini UHF N auf Mini-UHF

19.23

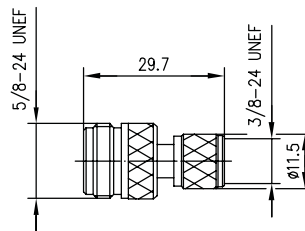

Order No. Bestell-Nr.	Remarks Anmerkungen
J01027F0011	f-m Bu-Sti

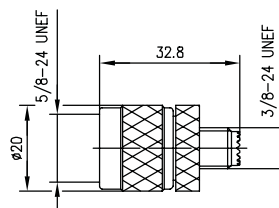

Order No. Bestell-Nr.	Remarks Anmerkungen
J01027F0012	m-f Sti-Bu

Inter-Series Adaptors Adapter zwischen den Serien

19.24

N to FME N auf FME

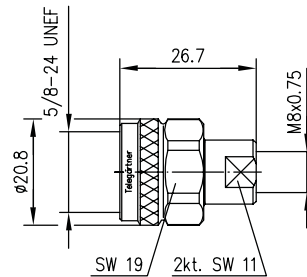

Order No. Bestell-Nr.	Remarks Anmerkungen	Return Loss Return Loss
J01027A0013	m-m Sti-Sti	28 dB/1.8 GHz

19.25

Angle Adaptor N to FME Winkeladapter N auf FME

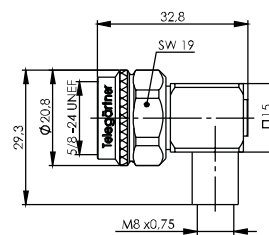

Order No. Bestell-Nr.	Remarks Anmerkungen	Return Loss Return Loss
J01027C0020	m-m Sti-Sti	25 dB/1.8 GHz

19.26

N to SMA N auf SMA

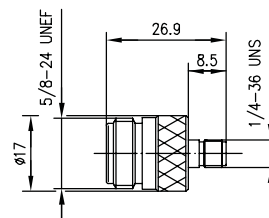
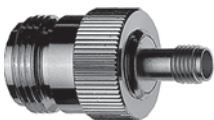

Order No. Bestell-Nr.	Remarks Anmerkungen	Return Loss Return Loss
J01027A0017	f-f Bu-Bu	42 dB/1 GHz; 26 dB/6 GHz

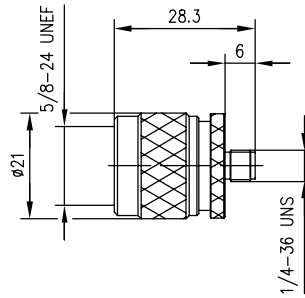
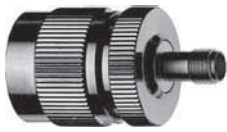

Order No. Bestell-Nr.	Remarks Anmerkungen	Return Loss Return Loss
J01027A0018	m-f Sti-Bu	37 dB/1 GHz; 23 dB/6 GHz

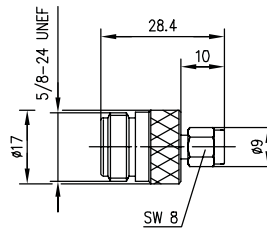

Order No. Bestell-Nr.	Remarks Anmerkungen	Return Loss Return Loss
J01027A0016	f-m Bu-Sti	38 dB/1 GHz; 21 dB/6 GHz

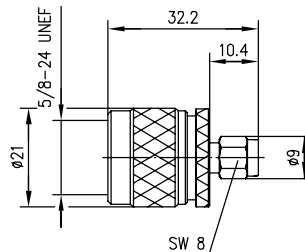

Order No. Bestell-Nr.	Remarks Anmerkungen	Return Loss Return Loss
J01027A0019	m-m Sti-Sti	39 dB/1 GHz; 25 dB/6 GHz

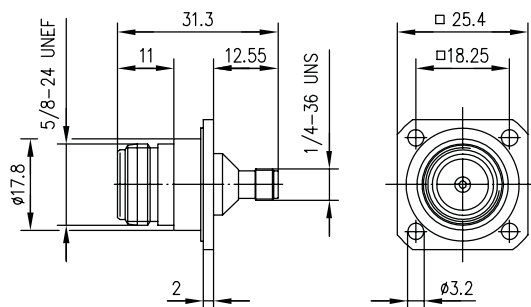
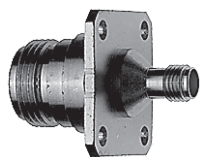

Order No. Bestell-Nr.	Remarks Anmerkungen	Mount. dim. Einbaumaß	Return Loss Return Loss
J01027B0008	f-f panel Bu-Bu mit Flansch	Z53	33 dB/1 GHz; 22 dB/4 GHz

Inter-Series Adaptors Adapter zwischen den Serien

19.26

N to SMA N auf SMA

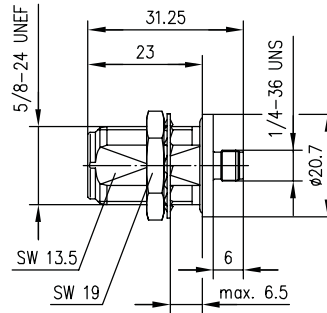

Order No. Bestell-Nr.	Remarks Anmerkungen	Mount. dim. Einbaumaß
J01027A0022	f-f bulkhead adaptor Bu-Bu Einbauadapter	Z10

19.27

UHF to N UHF auf N

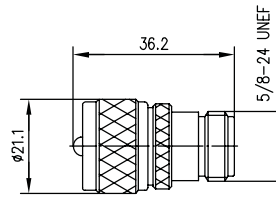

Order No. Bestell-Nr.	Remarks Anmerkungen	MIL-Std. MIL-Std.
J01043A0831	m-f Sti-Bu	UG-83 B/U

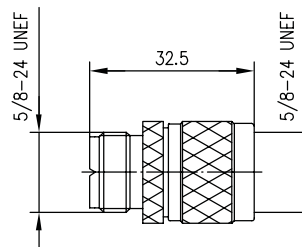

Order No. Bestell-Nr.	Remarks Anmerkungen	MIL-Std. MIL-Std.
J01043A0832	f-m Bu-Sti	UG-146 /U

UHF to Mini UHF UHF auf Mini-UHF

19.28

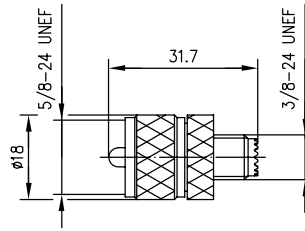

Order No. Bestell-Nr.	Remarks Anmerkungen
J01043F0002	m-f Sti-Bu

UHF to FME UHF auf FME

19.29

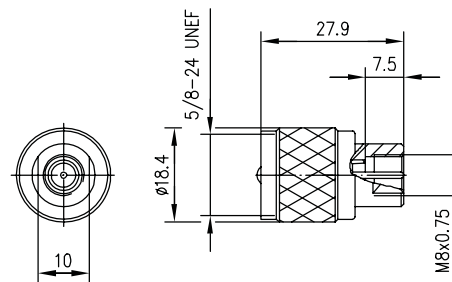

Order No. Bestell-Nr.	Remarks Anmerkungen
J01043A0000	m-m Sti-Sti

Mini UHF to FME Mini-UHF auf FME

19.30

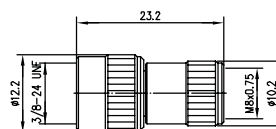

Order No. Bestell-Nr.	Remarks Anmerkungen
J01048A0000	m-m Sti-Sti

19.31

Angle Adaptor Mini UHF to FME Winkeladapter Mini-UHF auf FME

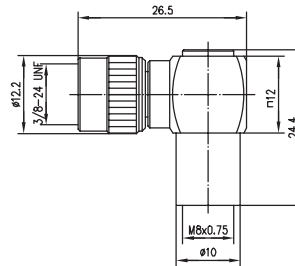
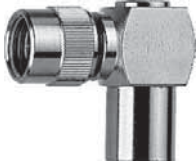

Order No. Bestell-Nr.	Remarks Anmerkungen
J01048A0002	m-m Sti-Sti

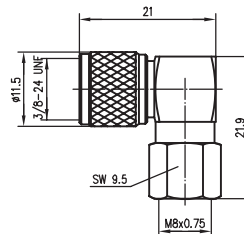

Order No. Bestell-Nr.	Remarks Anmerkungen
J01048F0002	m-m Sti-Sti

19.32

M to FME M auf FME

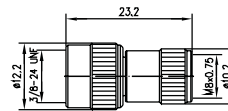

Order No. Bestell-Nr.	Remarks Anmerkungen
J01053A0000	m-m Sti-Sti

FME to SMA FME auf SMA

19.33

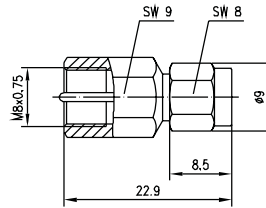

Order No. Bestell-Nr.	Remarks Anmerkungen
J01703A0009	m-m Sti-Sti

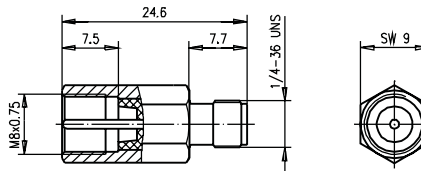

Order No. Bestell-Nr.	Remarks Anmerkungen
J01703A0000	m-f Sti-Bu

SMA to SMB SMA auf SMB

19.34

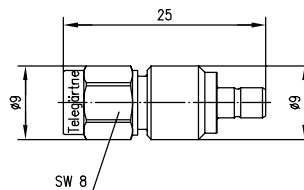

Order No. Bestell-Nr.	Remarks Anmerkungen	Return Loss
J01155A0021	m-m Sti-Sti	32 dB/1 GHz; 25 dB/4 GHz

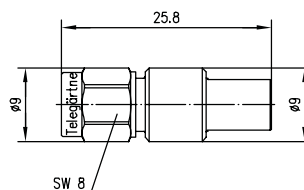

Order No. Bestell-Nr.	Remarks Anmerkungen	Return Loss
J01155A0031	m-f Sti-Bu	32 dB/1 GHz; 25 dB/4 GHz

19.34

19.34

SMA to SMB SMA auf SMB

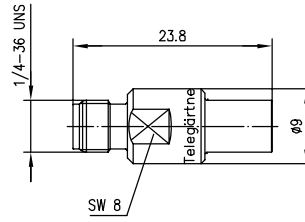

Order No. Bestell-Nr.	Remarks Anmerkungen	Return Loss Return Loss
J01155A0041	f-f Bu-Bu	32 dB/1 GHz; 25 dB/4 GHz

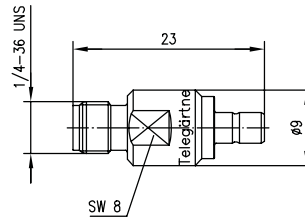

Order No. Bestell-Nr.	Remarks Anmerkungen	Return Loss Return Loss
J01155A0051	f-m Bu-Sti	32 dB/1 GHz; 25 dB/4 GHz

19.35

7/16 to N 7-16 auf N

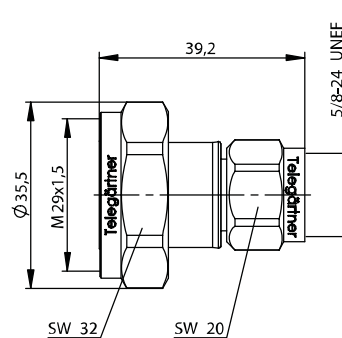

Order No. Bestell-Nr.	Remarks Anmerkungen	Return Loss Return Loss
J01122C0009	m-m Sti-Sti	44.5 dB/1 GHz; 32 dB/6 GHz

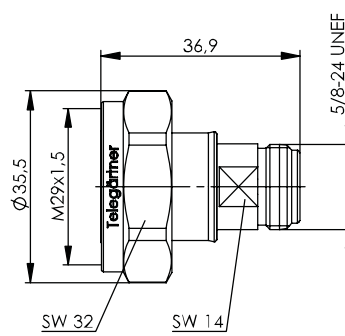

Order No. Bestell-Nr.	Remarks Anmerkungen	Return Loss Return Loss
J01122B0010	m-f Sti-Bu	44.5 dB/1 GHz; 32 dB/6 GHz

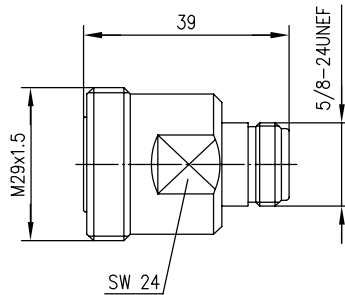
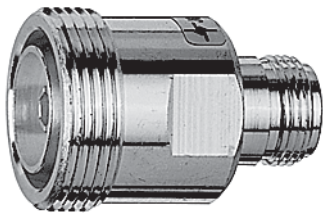

Order No. Bestell-Nr.	Remarks Anmerkungen	Return Loss Return Loss
J01122A0008	f-f Bu-Bu	44 dB/1 GHz, 40 dB/2.5 GHz, 32 dB/6 GHz

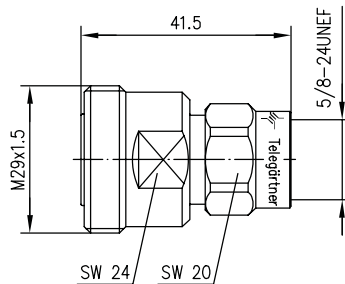

Order No. Bestell-Nr.	Remarks Anmerkungen	Return Loss Return Loss
J01122A0011	f-m Bu-Sti	44 dB/1 GHz, 40 dB/2.5 GHz, 32 dB/6 GHz

Inter-Series Adaptors Adapter zwischen den Serien

19.36

Bulkhead Adaptor R-SMA to UMTC (U.FL) Einbauadapter R-SMA auf UMTC (U.FL)

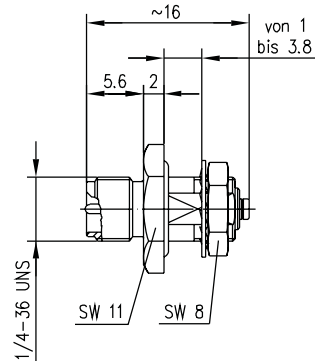

Order No. Bestell-Nr.	Remarks Anmerkungen	Mount. dim. Einbaumaß
J01155R0061	f reverse - m Bu Reverse - Sti	Z36

19.37

SMA to R-SMA SMA auf R-SMA

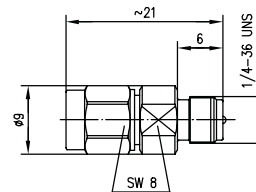

Order No. Bestell-Nr.	Remarks Anmerkungen
J01155R0085	m-f reverse Sti-Bu Reverse

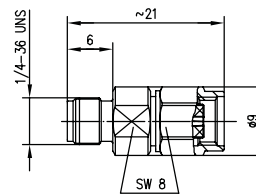
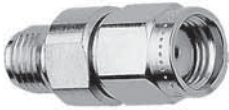

Order No. Bestell-Nr.	Remarks Anmerkungen
J01155R0095	f-m Reverse Bu-Sti Reverse

TNC to R-TNC TNC auf R-TNC

19.38

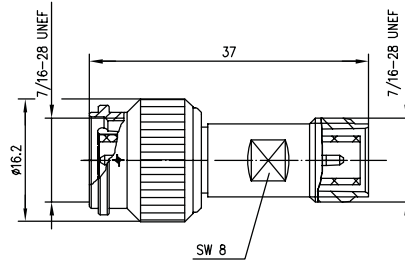

Order No. Bestell-Nr.	Remarks Anmerkungen
J01014R0000	m-f reverse Sti-Bu Reverse

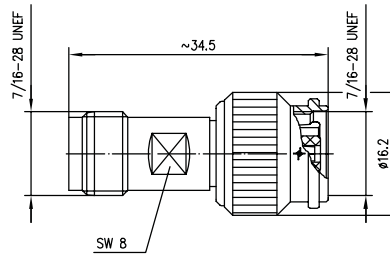
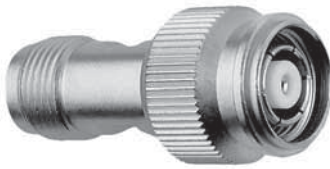

Order No. Bestell-Nr.	Remarks Anmerkungen
J01014R0001	f-m Reverse Bu-Sti Reverse

SMA to Push-On SMA SMA auf Push-On SMA

19.39

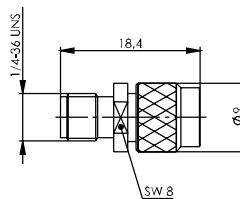

Order No. Bestell-Nr.	Remarks Anmerkungen
J01155A0099	f-m Bu-Sti

19.40

QLS to SMA
QLS auf SMA

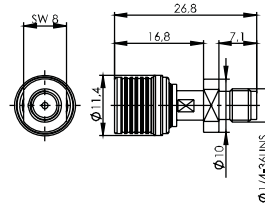

Order No.
Bestell-Nr.

J01423A0000

Remarks

Anmerkungen

m-f

Sti-Bu

Return Loss

Return Loss

2 GHz/38 dB; 4 GHz/31 dB

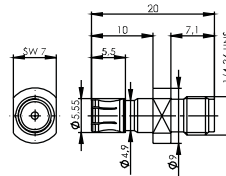

Order No.
Bestell-Nr.

J01423A0001

Remarks

Anmerkungen

f-f

Bu-Bu

Return Loss

Return Loss

2 GHz/38 dB; 4 GHz/31 dB